

# BMI Icopal Tecnatorch

## Concrete Deck: Warm Roof System

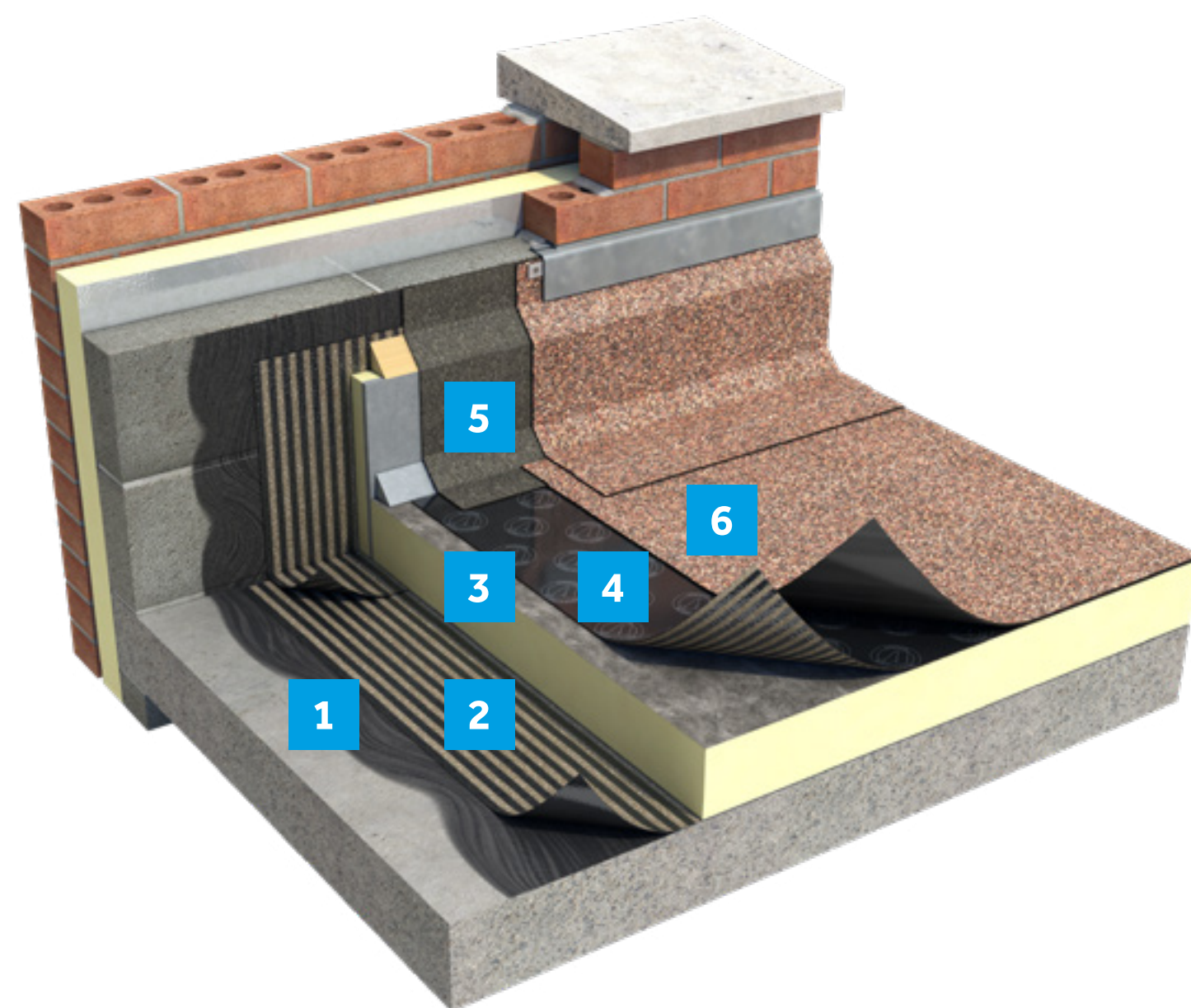

### System features and benefits

- Safer low-flame application thanks to our technically advanced, low-heat-reactive SBS modified bitumen formulation
- A range of capsheet colours are available to suit every project
- Designed and manufactured in the UK to meet our unique environment and project demands
- Tecnatorch is one of the UK's most trusted flat roofing systems, used by generations of roofing professionals nationwide
- Tecnatorch brings the roof performance you'd expect from Icopal to every kind of flat roofing project, with robust, durable materials that you can rely on to help you deliver a professional finish
- Widely available nationwide from specialist stockists
- Easy to handle, work with and install to a quality finish
- Reduced gas consumption and faster installation thanks to our unique mini groove profile technology
- Tecnatorch can be covered by an Icopal product guarantee of up to 20 years, as well as the option of a full 15-year system guarantee when installed by an Icopal-approved contractor

System layer	Product
1 Primer	Siplast Primer
2 Vapour control	Total Torch AVCL
3 Insulation	Thermazone Torch-On
4 Underlay	Total Torch VDL
5 Detailing underlay	Tecnatorch Sand
6 Cap sheet	Tecnatorch

### Pride. Passion. Performance.

Tecnatorch is our pioneering, torch-on bitumen system for flat roofing projects. It's tried and tested. And it's been trusted by generations of roofing professionals. Because Tecnatorch is a complete system that makes it easier to achieve roofing you can be proud of. Just like it's always helped roofers build their own reputation for excellence across the decades. Above all, Tecnatorch was developed to focus on what matters: performance.



[Explore our specification support](#)

### Specifying Tecnatorch

Tecnatorch is a versatile roofing system and can be used with the following suitably prepared deck types: plywood, OSB3, timber boarding, profiled metal decking and concrete/screeded surfaces.

[Explore our product brochure](#)

### End-to-end peace of mind

Designed for ease and speed of installation, Tecnatorch's consistent performance and range of guarantees makes it the go-to bituminous flat roofing system. Partnering with BMI Icopal not only gives you long-term confidence, it also gives you a lifetime of in-depth support from experts who take pride in helping you achieve a roof you can be proud of.

[View our support and services](#)

# BMI Icopal Tecnatorch

## System Variations: Warm Roof System

### TECNA TORCH PLY OR OSB SUBSTRATE

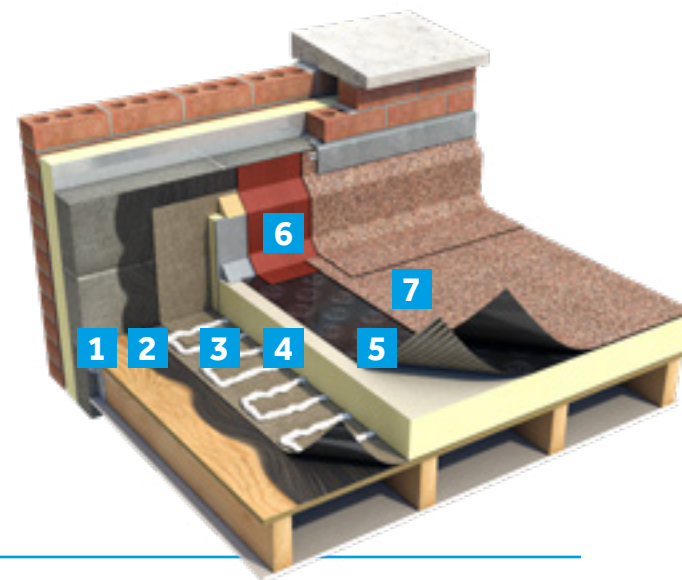

System layer	Product
1	Preparation <b>HT125 Tape</b>
2	Primer <b>SA Primer</b>
3	Vapour control <b>Torchsafe TA AVCL Sand</b>
4	Insulation <b>Thermazone Roofboard</b>
5	Underlay <b>TorchSafe TA Underlay</b>
6	Detailing underlay <b>Torchsafe TA Detailing Underlay</b>
7	Cap sheet <b>Tecnatorch</b>

### TECNA TORCH OVERLAY/BUR

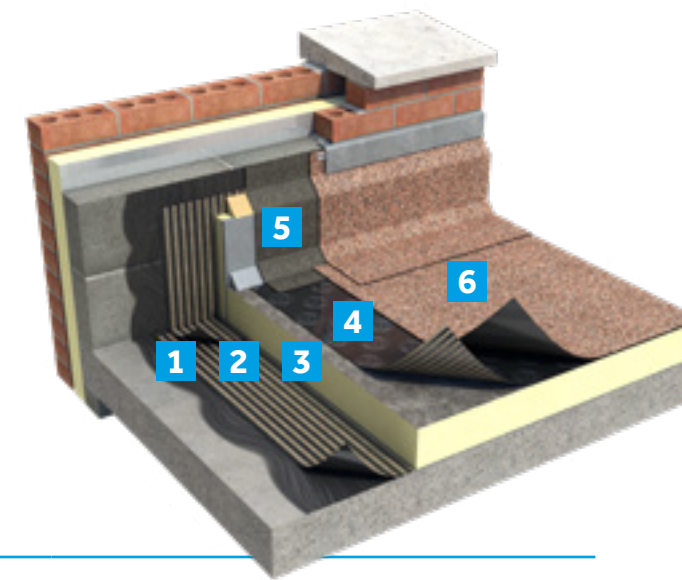

System layer	Product
1	Primer <b>Siplast Primer</b>
2	Vapour control <b>Total Torch AVCL</b>
3	Insulation <b>Thermazone Torch-On</b>
4	Underlay <b>Total Torch VDL</b>
5	Detailing underlay <b>Torchsafe TA Detailing Underlay</b>
6	Cap sheet <b>Tecnatorch</b>

### TECNA TORCH PROFILED METAL DECK SUBSTRATE

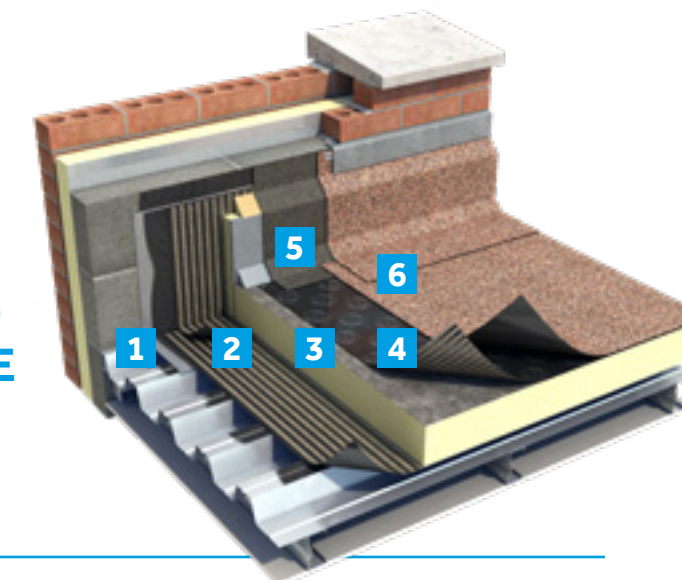



System layer	Product
1	Primer <b>SA Primer</b>
2	Vapour control <b>TorchSafe TA AVCL Stripe</b>
3	Insulation <b>Thermazone Torch-On</b>
4	Underlay <b>Total Torch VDL</b>
5	Detailing underlay <b>Torchsafe TA Detailing Underlay</b>
6	Cap sheet <b>Tecnatorch</b>

NOTE: These are example systems, for project specific specifications, please [contact our technical services department](#)

### Backed by BMI Icopal

In addition to delivering a lifetime of safety, proven performance and low maintenance, Tecnatorch is also backed by the tailored service of BMI Icopal's specification and technical team. This means you'll benefit from complete consistency and certainty from start to finish.

#### Services include:

-  Comprehensive roof surveys
-  BBA certification
-  On-site quality control checks
-  Tapered insulation design
-  U-value calculations
-  Wind load calculations
-  Condensation risk analysis
-  [Explore the full scope of Tecnatorch support](#)



### TorchSafe™

Safe2Torch-compliant systems available, incorporating TorchSafe™ membrane technology, for enhanced safety during application



### Why choose Tecnatorch?

Tecnatorch has been trusted by roofing professionals throughout the years. Partnering with us means you can rely on the complete peace of mind that comes from the full, end-to-end service of Icopal.