

Single Ply Membrane Details

Fully adhered system

Eaves gutter detail

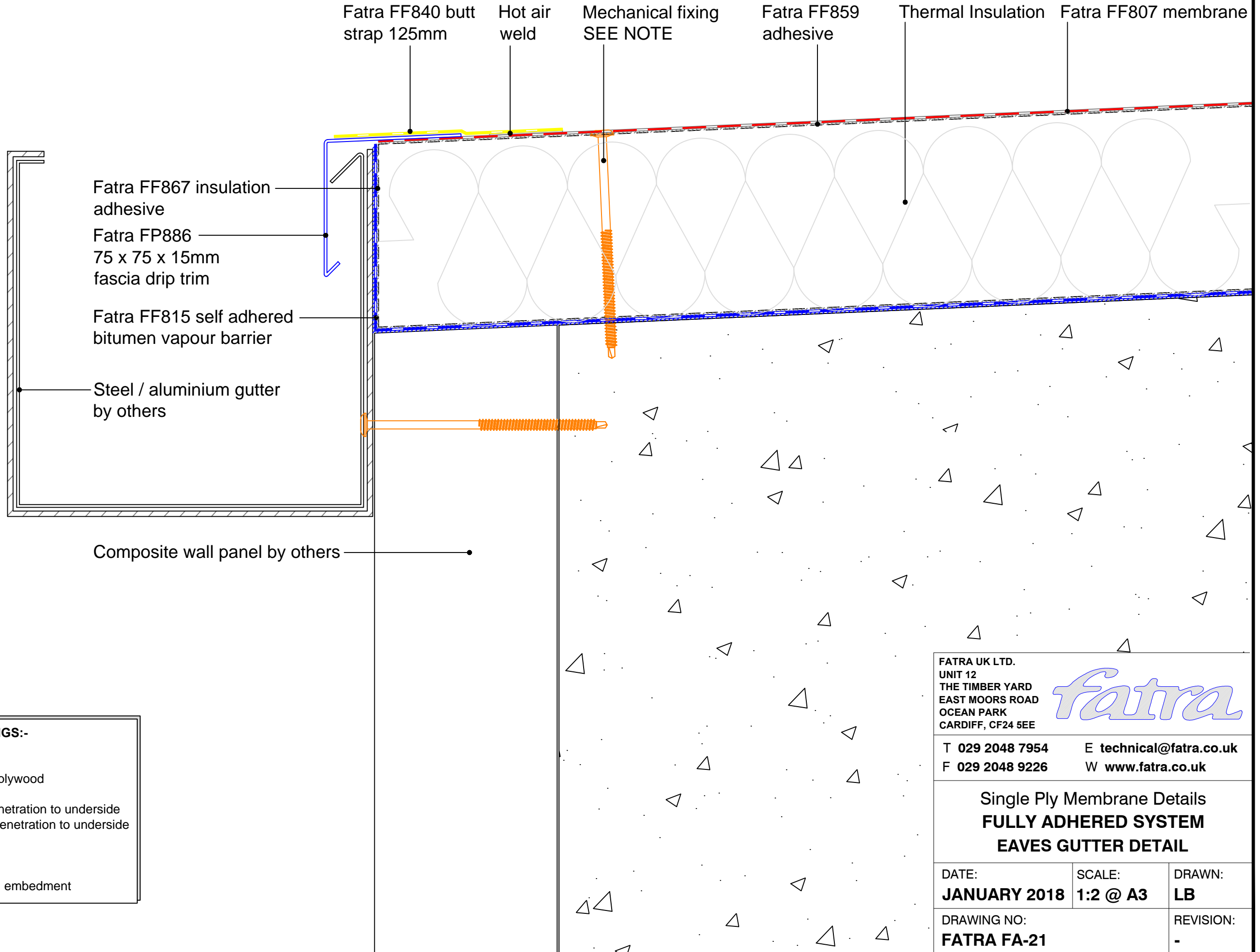

Fatra FF867 insulation adhesive

Fatra FP886
75 x 75 x 15mm
fascia drip trim

Fatra FF815 self adhered
bitumen vapour barrier

Steel / aluminium gutter
by others

Composite wall panel by others

MECHANICAL FIXINGS:-

Selection of fixings:-
Deck - Metal/Timber/plywood
FBS-5.8 fasteners
Metal deck 15mm penetration to underside
Timber deck 12mm penetration to underside

Deck - Concrete
FHD-6.1 fasteners
Concrete deck 25mm embedment

FATRA UK LTD.
UNIT 12
THE TIMBER YARD
EAST MOORS ROAD
OCEAN PARK
CARDIFF, CF24 5EE



T 029 2048 7954 E technical@fatra.co.uk
F 029 2048 9226 W www.fatra.co.uk

Single Ply Membrane Details
FULLY ADHERED SYSTEM
EAVES GUTTER DETAIL

DATE: JANUARY 2018	SCALE: 1:2 @ A3	DRAWN: LB
------------------------------	---------------------------	---------------------

DRAWING NO: FATRA FA-21	REVISION: -
-----------------------------------	----------------