

**Single Ply Membrane Details**  
**Mechanically Fixed System**  
**Fascia drip trim detail**

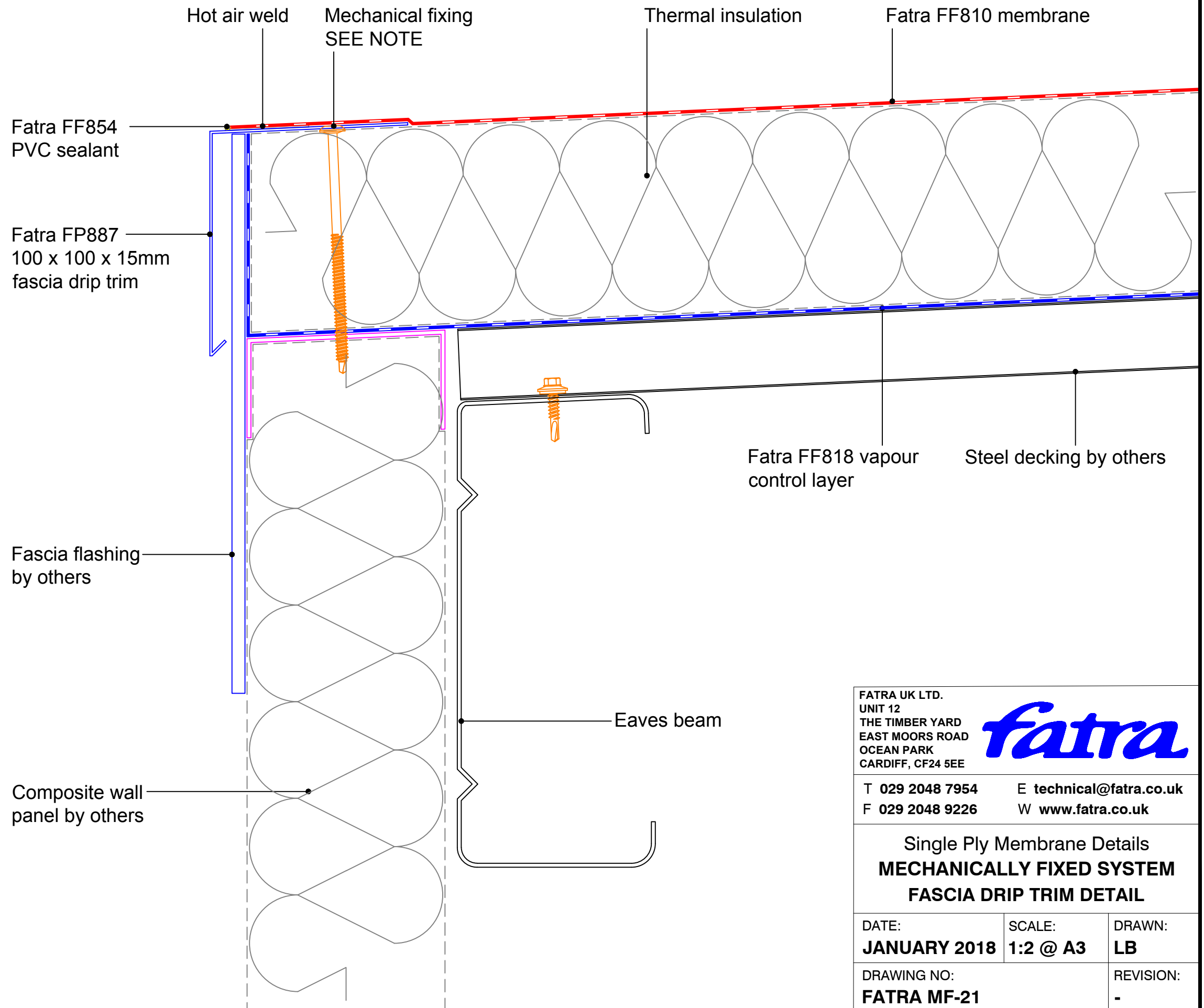

**MECHANICAL FIXINGS:-**

Selection of fixings:-  
 Deck - Metal/Timber/plywood  
 FBS-5.8 fasteners  
 Metal deck 15mm penetration to underside  
 Timber deck 12mm penetration to underside

Deck - Concrete  
 FHD-6.1 fasteners  
 Concrete deck 25mm embedment

FATRA UK LTD. UNIT 12 THE TIMBER YARD EAST MOORS ROAD OCEAN PARK CARDIFF, CF24 5EE		
		
T 029 2048 7954	E technical@fatra.co.uk	
F 029 2048 9226	W www.fatra.co.uk	
Single Ply Membrane Details <b>MECHANICALLY FIXED SYSTEM</b> <b>FASCIA DRIP TRIM DETAIL</b>		
DATE: <b>JANUARY 2018</b>	SCALE: <b>1:2 @ A3</b>	DRAWN: <b>LB</b>
DRAWING NO: <b>FATRA MF-21</b>		REVISION: -