

Single Ply Membrane Details

Fully adhered system

Fascia drip trim detail

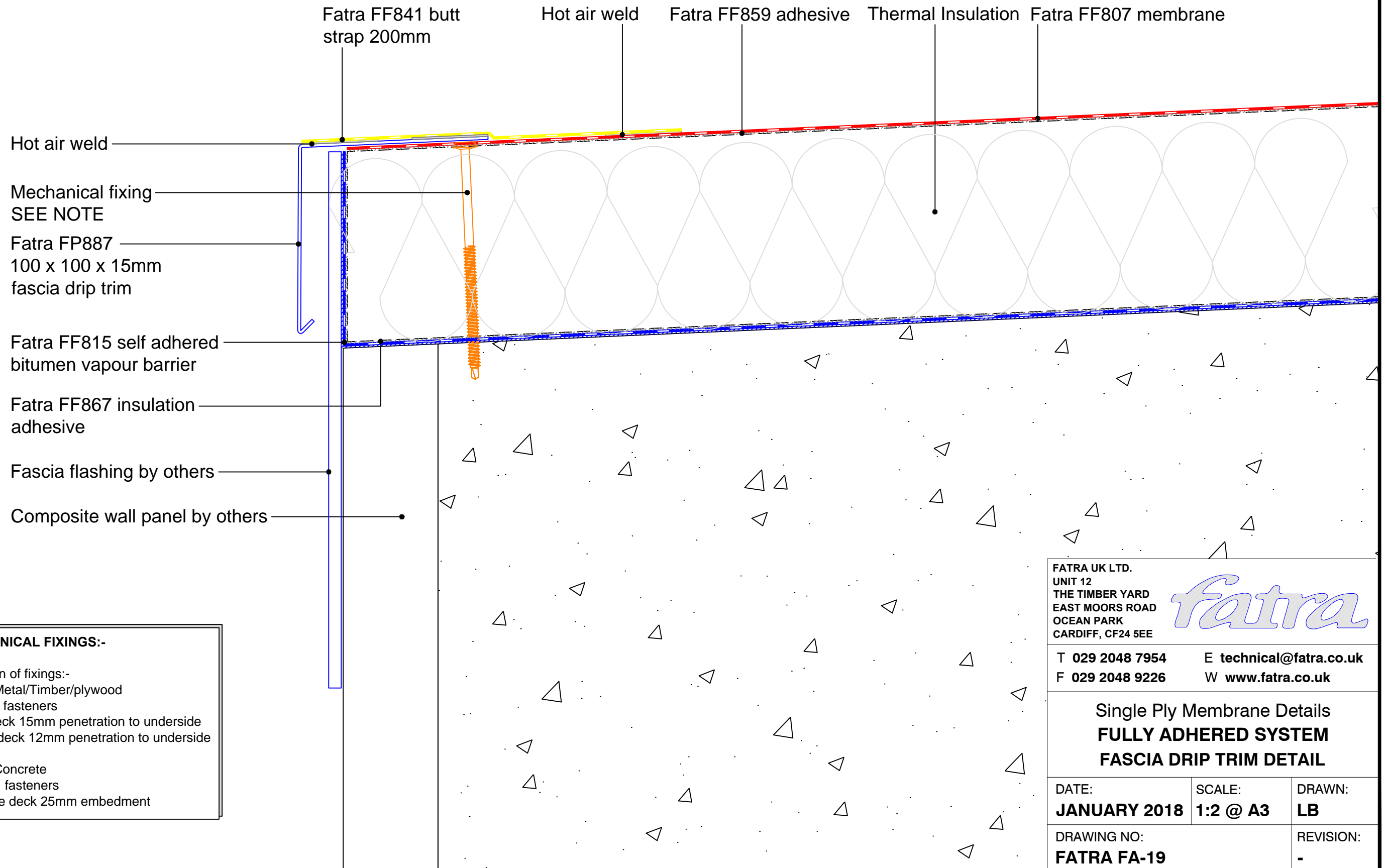

MECHANICAL FIXINGS:-

Selection of fixings:-
 Deck - Metal/Timber/plywood
 FBS-5.8 fasteners
 Metal deck 15mm penetration to underside
 Timber deck 12mm penetration to underside

Deck - Concrete
 FHD-6.1 fasteners
 Concrete deck 25mm embedment

FATRA UK LTD. UNIT 12 THE TIMBER YARD EAST MOORS ROAD OCEAN PARK CARDIFF, CF24 5EE		
T 029 2048 7954 F 029 2048 9226	E technical@fatra.co.uk W www.fatra.co.uk	
Single Ply Membrane Details FULLY ADHERED SYSTEM FASCIA DRIP TRIM DETAIL		
DATE: JANUARY 2018	SCALE: 1:2 @ A3	DRAWN: LB
DRAWING NO: FATRA FA-19		REVISION: -