

Note:
All substrates are to be suitably prepared and primed as required in accordance with the project specification details, prior to the installation of the Polyroof waterproofing system.

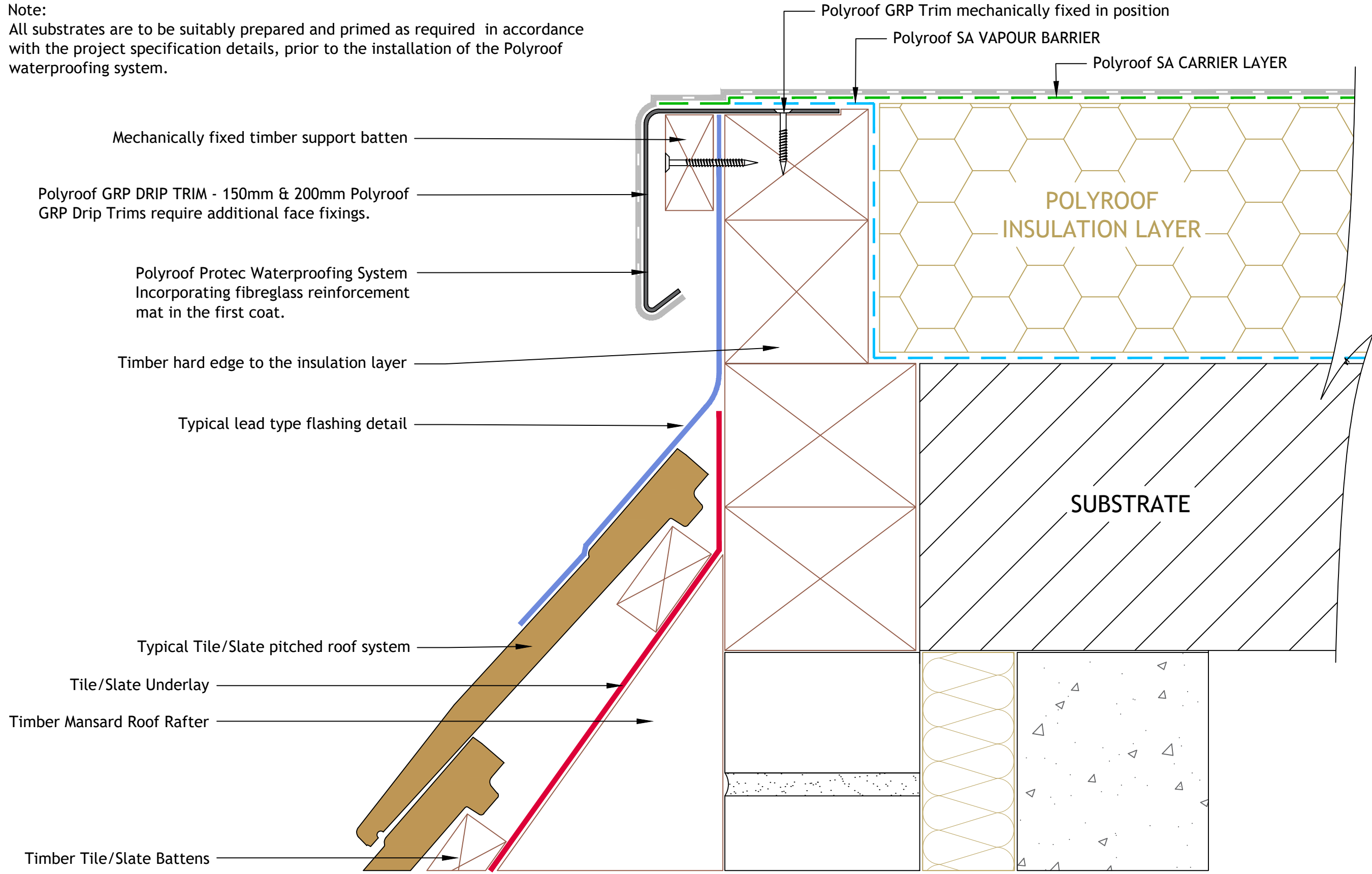

POLYROOF
ADVANCED LIQUID ROOFING

Castle Park Industrial Estate, Evans Street, Flint, CH6 5XA
T: 01352 735 135 E: admin@polyroof.co.uk W: polyroof.co.uk

DRAWING TITLE : Mansard Edge Detail - Warm Roof

POLYROOF SYSTEM : POLYROOF PROTEC RANGE

SCALE : Drawing not to scale at A3. The purpose of this drawing is for information only, DO NOT SCALE use featured dimensions only.

DRAWING No : PR22-049

DATE : 07-07-2022

DRAWN BY : B.Hill

REVISION No: R-001