

Single Ply Membrane Details

Fully adhered system

Cable penetration detail

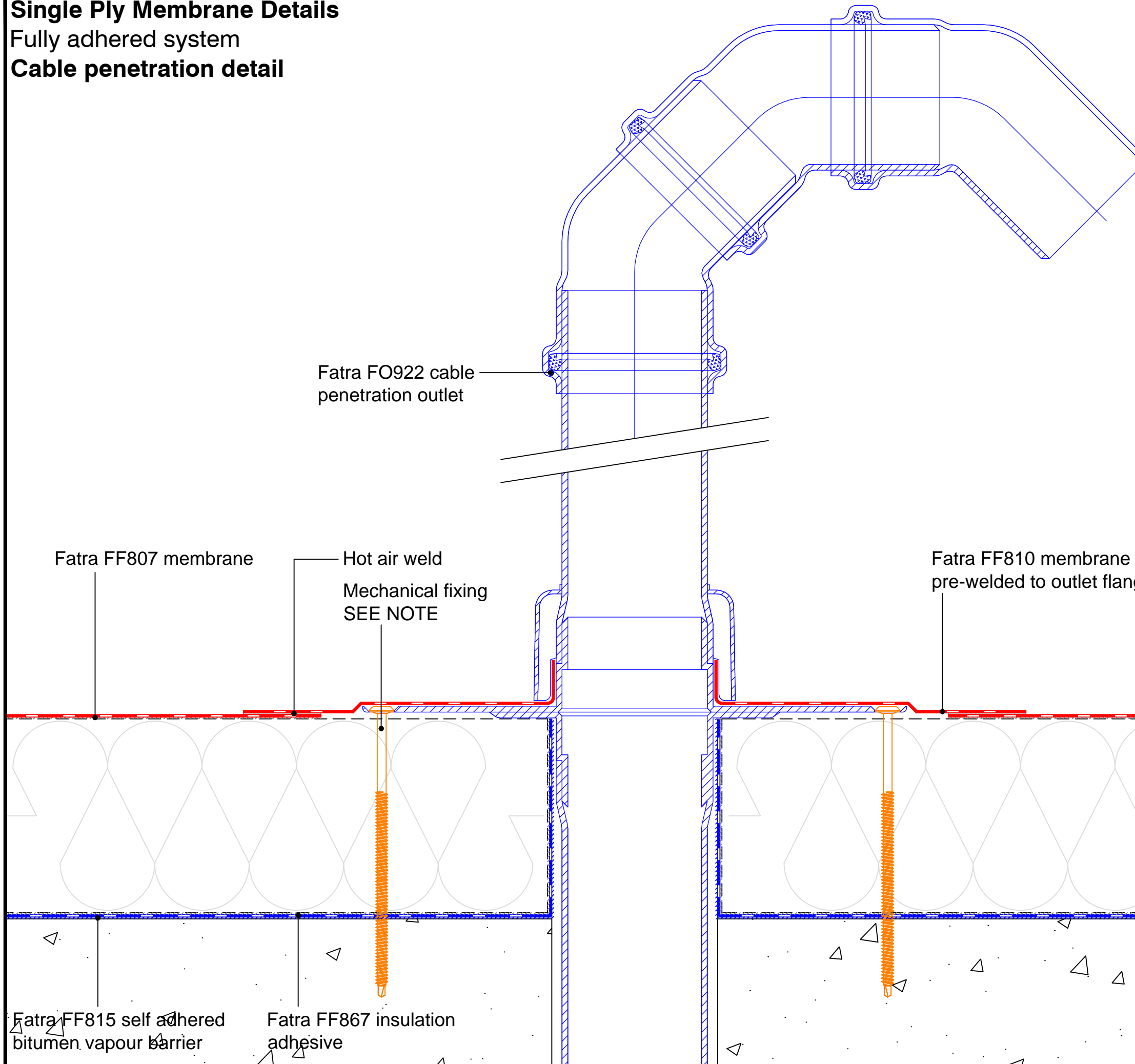

MECHANICAL FIXINGS:-

Selection of fixings:-
 Deck - Metal/Timber/plywood
 FBS-5.8 fasteners
 Metal deck 15mm penetration to underside
 Timber deck 12mm penetration to underside

Deck - Concrete
 FHD-6.1 fasteners
 Concrete deck 25mm embedment

Fatra FF807 membrane

Hot air weld
 Mechanical fixing
 SEE NOTE

Fatra FF810 membrane
 pre-welded to outlet flange

Thermal
 insulation

Fatra FF859
 adhesive

Fatra FF815 self adhered
 bitumen vapour barrier

Fatra FF867 insulation
 adhesive

FATRA UK LTD.
 UNIT 12
 THE TIMBER YARD
 EAST MOORS ROAD
 OCEAN PARK
 CARDIFF, CF24 5EE



T 029 2048 7954 E technical@fatra.co.uk
 F 029 2048 9226 W www.fatra.co.uk

Single Ply Membrane Details
FULLY ADHERED SYSTEM
CABLE PENETRATION DETAIL

DATE: JANUARY 2018	SCALE: 1:2 @ A3	DRAWN: LB
DRAWING NO: FATRA FA-27		REVISION: -