

Single Ply Membrane Details

Fully adhered system

Smoke vent detail

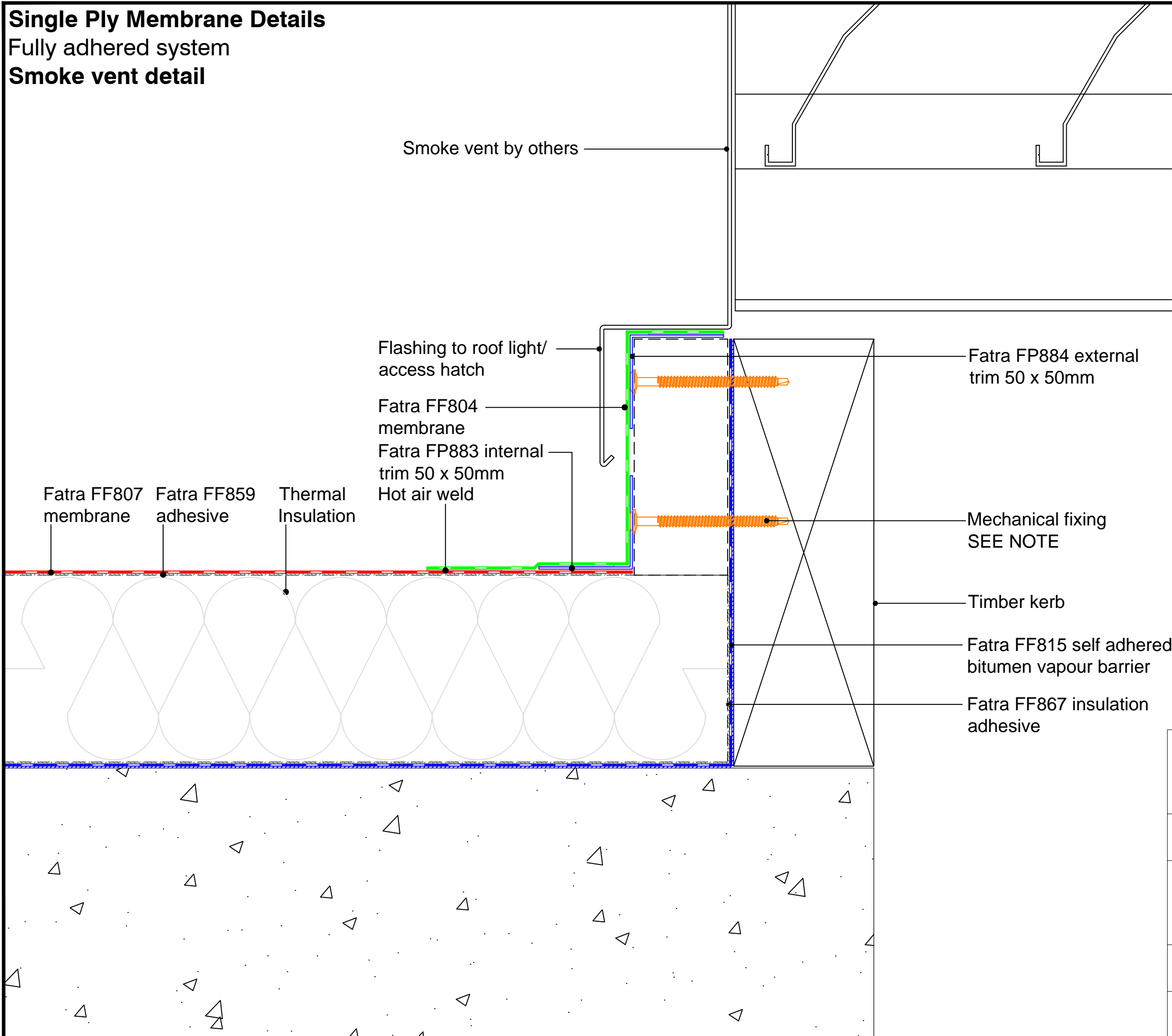

MECHANICAL FIXINGS:-

- Selection of fixings:-
- Deck - Metal/Timber/plywood
- FBS-5.8 fasteners
- Metal deck 15mm penetration to underside
- Timber deck 12mm penetration to underside

- Deck - Concrete
- FHD-6.1 fasteners
- Concrete deck 25mm embedment

FATRA UK LTD.
 UNIT 12
 THE TIMBER YARD
 EAST MOORS ROAD
 OCEAN PARK
 CARDIFF, CF24 5EE



T 029 2048 7954 E technical@fatra.co.uk
 F 029 2048 9226 W www.fatra.co.uk

Single Ply Membrane Details
FULLY ADHERED SYSTEM
SMOKE VENT DETAIL

DATE: JANUARY 2018	SCALE: 1:2 @ A3	DRAWN: LB
------------------------------	---------------------------	---------------------

DRAWING NO: FATRA FA-46	REVISION: -
-----------------------------------	-----------------------