

XTRAFLEX SYSTEM

TECHNICAL DATA SHEET

Version: 2.0
Dated: 13/05/2022

POLYROOF
ADVANCED LIQUID ROOFING

Part of
**Roberts
Group**

Introduction

With its fast curing technology and imperviousness to standing water, the system provides a rapid solution that offers lasting performance even in zero fall applications. The XtraFlex System shares the same chemical backbone as the existing tried and tested Protec System and will therefore provide the same long term durability and performance.

The XtraFlex System can be applied directly to virtually all metal surfaces, Plastisol-coated metal, concrete finlock gutters and a range of other surfaces.

Key Features

- Enhanced Flexibility Ideal for Industrial Gutters
- Impervious to standing water
- *RapidCure* Technology
- Seamless Waterproof Membrane
- Cold Applied Installation with Zero Risks from Hot Works
- Direct Application

Typical System Build Up

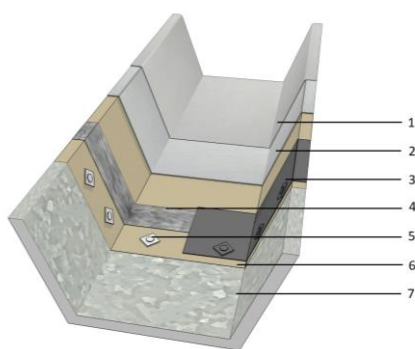

1. XtraFlex 2nd Coat
2. XtraFlex 1st Coat and PolyMat 450 reinforcement
3. Local reinforcements to Laps and Bolts - Xtraflex and Polymat 450 (300mm Wide)
4. 75mm Polyroof Butyl Lap Tape
5. 50mm x 50mm Polyroof Butyl Bolt Tape
6. Polyroof Quick Dry 2-Pack Epoxy Primer
7. Metal Gutter

Colours & Finishes

XtraFlex is pre-pigmented in Light Grey.



Physical Properties

| Test | Result |
|-------------------------|--------|
| Thickness (mm) | 2.05 |
| Weight / m ² | 2.70 |

Maintenance

The system does not require any ongoing maintenance by the manufacturer, however standard biannual inspections and standard flat roof maintenance, good practice should be followed by clients as recommended in BS6229.

Packaging

| Product | Pack Size | Code |
|--|------------------------|--------|
| XtraFlex Resin | 10.0 litre | 121304 |
| XtraFlex Accelerator | 434g | 121409 |
| XtraFlex Inhibitor | 150g | 121321 |
| Polyroof Powder Catalyst | 1 Kg | 102003 |
| PolyMat 450 | 17m ² rolls | 104003 |
| PolyMat 450 | 30m ² rolls | 104016 |
| Taping Mat 300mm | 18 lm | 104021 |
| Polyroof Quick Dry 2-Pack Epoxy Primer | 4.0 litre pack | 122066 |
| Polyroof Butyl Lap Tape | 75mm x 10m | 104401 |
| Polyroof Butyl Bolt Tape | 50mm x 15m | 104402 |

Shelf Life / Storage

Shelf life 12 Months for XtraFlex. This is based on unopened containers stored in dry, frost-free conditions away from heat.

Health & Safety

Workers should wear appropriate PPE as detailed in the safety data sheet. Safety Data Sheet available on request.

Specifying the System

Polyroof offer a free specification service. It is recommended that Polyroof Technical Services are contacted to provide specific advice on any project.

Application

The system must only be applied by contractors who have been trained and approved by Polyroof and have a valid contractor's certificate.

Temperature

The system may be applied between 3°C and 30°C (1°C and 30°C with Xtraflex accelerator). The system must not be applied in damp or cold conditions which could cause surface condensation; during frost or if there is a risk of rain.

Equipment

Apply using a Medium Pile Roller or Brush

Preparation

All structures should be sound and free from defects. Ensure all fittings (bolts, seals etc.) are in good order.

All surfaces to be coated (including any coatings, repairs or test areas) are to be inspected and made good where required to provide a sound substrate for the new waterproofing system.

Surfaces must be clean, dry and free from contaminants such as dust, oil, grease, organic growth, and free from corrosion. Any areas of fungal growth or moss should be treated with Polykill W Anti-Fungal Wash.

All rust, loose and flaking materials are to be removed by wire brush or other means and all debris removed. Any areas of significant rusting which cannot be removed should be treated with a suitable proprietary rust converter.

Thoroughly wipe metal surfaces with acetone prior to priming.

Note - To all new bright or un-weathered (non-oxidised) galvanized steel surfaces, Mordant T-

Wash will be required. Consult Technical Services for further guidance.

Priming

The requirement for a primer will be dependent on the substrate. It is recommended Polyroof Technical Services are contacted for advice on 0800 801 890.

| SURFACE | PRIMER |
|---|---|
| Metal Surfaces: | Polyroof Quick Dry 2-Pack Epoxy Primer Coverage Rate – 10-15m ² /litre Touch Dry – 30 mins Overcoat – Allow Minimum 2-4 Hours |
| Other Surfaces | Consult Polyroof Technical Services for guidance. |
| IMPORTANT | |
| For cure times of primers refer to Primer TDS or Manual | |

Summer Inhibitors

XtraFlex Summer Inhibitor extends the pot-life of the XtraFlex Resin which is invaluable when temperatures are high during the summer months. The XtraFlex Inhibitor can be added to XtraFlex Resin on site prior to use. It should only be added as temperature ranges permit.

IMPORTANT: XtraFlex Inhibitor is not designed as a replacement for the catalyst. After the XtraFlex Inhibitor has been added, you will still need to add the powder catalyst (at the minimum rate of 2%) before you use the product.

Add a full tin of XtraFlex Inhibitor in to a full tin of resin and stir thoroughly (taking care to ensure the full contents are transferred). Mix thoroughly to ensure that the XtraFlex Inhibitor is evenly distributed in the resin. You may use a light mechanical mixer if required (EPI Mixer or similar).

Once the XtraFlex Inhibitor is mixed into the resin you can pour into smaller quantities if required e.g. 5 or 2 litres (Sometimes useful if you are unsure how much working time you have).

Only when you are ready to use the product should you add the catalyst powder.

Winter Accelerators

Xtraflex winter accelerators may be required for winter / low temperature applications. Winter accelerators speed up cure and allow product to be laid at lower temperatures than standard product (down as low as 1°C deck temperature). The accelerators are contained in an additive that can be added to standard resin products on site prior to use. They should be added only as temperature ranges permit.

IMPORTANT: Accelerators are not designed as a replacement for the catalyst. After the XtraFlex accelerator has been added, you will need to add the powder catalyst (at the maximum rate of 4% in cold conditions) before you use the product.

Add a full tin of accelerator in a full tin of resin and stir thoroughly. Mix thoroughly to ensure that the accelerator is evenly distributed in the resin. You may use a light mechanical mixer if required (EPI Mixer or similar).

Once the accelerator is mixed into the resin you can pour into smaller quantities if required e.g. 5 or 2 litres (Sometimes useful if you are unsure how much working time you have).

Only when you are ready to use the product should you add the catalyst powder

Catalyst

The Catalyst should be added to the XtraFlex resin. The minimum level of catalyst is 2% (**2 measuring spoons per litre of resin**). Ensure the catalyst is thoroughly mixed prior to use.

| Temperature | Catalyst Addition Rate | Scoops Per Litre |
|-------------|------------------------|------------------|
| 3-10°C | 4% | 4 scoops |
| 10-15°C | 3% | 3 scoops |
| 15-20°C | 2-3% | 2-3 scoops |
| 20-30°C | 2% | 2 scoops |

Local Reinforcements / Detailing

Lap Joints & Bolt Heads: To all lap joints apply 75mm wide Polyroof Butyl Lap Tape and to all bolt heads apply 50mm x 50mm Polyroof Butyl Bolt Tape.

Apply one overall coat of XtraFlex Resin and 300mm wide PolyMat 450 at a minimum coverage rate of 1.3 - 1.5 Litres/m² (**0.66 - 0.77m²/Litre**) to locally reinforce the lap joints and bolt heads before application of main system. Allow to cure.

Note – Butyl tapes should be used prior to locally reinforcing the area with XtraFlex and 300mm wide Polymat 450. Separate Technical Datasheets are available for these products

Other Details – For local reinforcement of other details consult technical services.

Main System / Coverage Rates

Apply 1st coat of XtraFlex Resin and Polymat 450 in accordance with the coverage rates table below:

| 1 st Coat |
|---|
| 1.3-1.5 Litre / m ² (with PolyMat 450) |

Apply 2nd coat of XtraFlex Resin in accordance with the coverage rates table below:

| 2 nd Coat |
|-----------------------------|
| 0.5 Litres / m ² |

Allow additional material for uneven or rough substrates.

Cure Time (Per Coat)

Typically 45mins - 1 hr

(Incorporating XtraFlex Accelerator and catalyst as required)

Disclaimer

This datasheet is for general information only. Installers must refer to the application manual for full installation guidance.

Polyroof Products reserve the right to amend product specifications without prior notice. The information provided in this literature is given in good faith. Recommendations for use should be verified to ensure compliance with all current building regulations and standards. Please check that this data sheet is the latest

XTRAFLEX SYSTEM

TECHNICAL DATA SHEET

Polyroof.co.uk

0800 801 890

version by contacting technical services on
0800 801890 or visiting www.polyroof.co.uk/.

• ADVISE • DESIGN •
• GUARANTEE • SUPPORT •

POLYROOF
ADVANCED LIQUID ROOFING

Part of
**Roberts
Group**