

Single Ply Membrane Details
 Mechanically Fixed System
Roof parapet with timber decking detail

MECHANICAL FIXINGS:-

Selection of fixings:-
 Deck - Metal/Timber/plywood
 FBS-5.8 fasteners
 Metal deck 15mm penetration to underside
 Timber deck 12mm penetration to underside

Deck - Concrete
 FHD-6.1 fasteners
 Concrete deck 25mm embedment

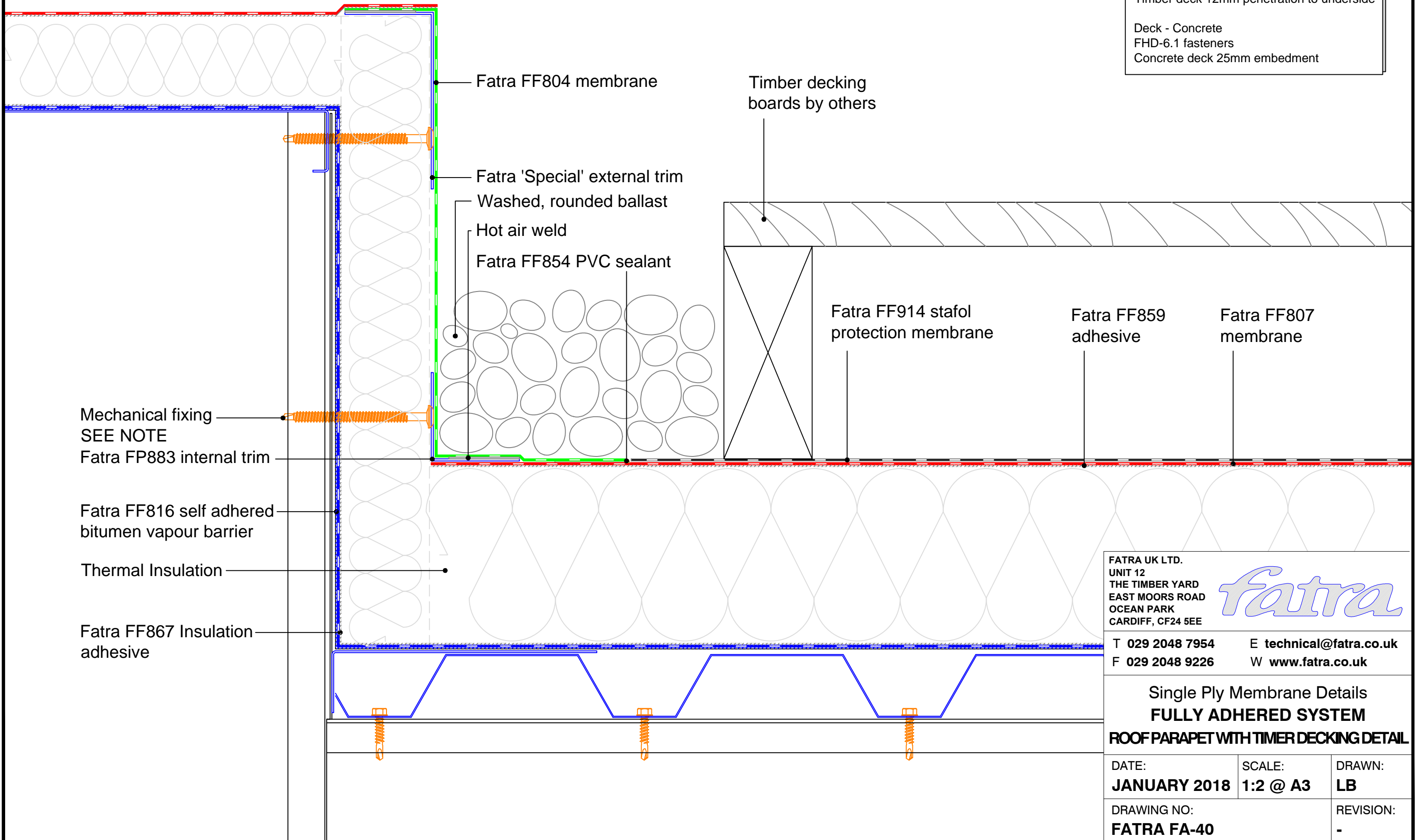

Mechanical fixing
 SEE NOTE
 Fatra FP883 internal trim

Fatra FF816 self adhered
 bitumen vapour barrier

Thermal Insulation

Fatra FF867 Insulation
 adhesive

Fatra FF804 membrane

Timber decking
 boards by others

Fatra 'Special' external trim
 Washed, rounded ballast
 Hot air weld
 Fatra FF854 PVC sealant

Fatra FF914 stafol
 protection membrane

Fatra FF859
 adhesive

Fatra FF807
 membrane

FATRA UK LTD.
 UNIT 12
 THE TIMBER YARD
 EAST MOORS ROAD
 OCEAN PARK
 CARDIFF, CF24 5EE



T 029 2048 7954 E technical@fatra.co.uk
 F 029 2048 9226 W www.fatra.co.uk

Single Ply Membrane Details
FULLY ADHERED SYSTEM
ROOF PARAPET WITH TIMBER DECKING DETAIL

DATE: JANUARY 2018	SCALE: 1:2 @ A3	DRAWN: LB
DRAWING NO: FATRA FA-40		REVISION: -